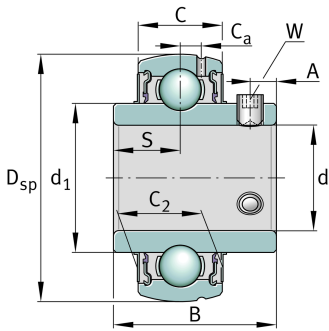

**GYE25-KRR-B-FA107-VA-HLA** [↗](#)

Radial insert ball bearing

Radial insert ball bearing GYE...KRR-B-FA107-VA

Technical information

**Main Dimensions & Performance Data**

d	25 mm	Bore diameter
D _{SP}	52 mm	Outside diameter
B	34,1 mm	Width
C _{0r}	7.800 N	Basic static load rating, radial
C _r	14.000 N	Basic dynamic load rating, radial
m	0,191 kg	Weight

Dimensions

C	17 mm	Width, outer ring
C ₂	17,6 mm	Sealing total width
S	14,3 mm	Distance raceway
d ₁	34,03 mm	Rib diameter inner ring
C _a	4,15 mm	Distance to lubrication hole
A	5 mm	Distance thread
W	2,5 mm	Width of flats



Characteristics

-  Radial load
-  Axial load in one direction
-  Axial load in two directions
-  Lifetime lubrication, freedom from maintenance
-  Grease Lubrication
-  Sealed on both sides
-  Protected against rust
-  Static angular error and misalignment