

**GYE45-XL-KRR-B**

Radial insert ball bearing

Radial insert ball bearings GYE...-KRR-B,
spherical outer ring, location by grub screws,
R seals on both sides

X-life

Technical information

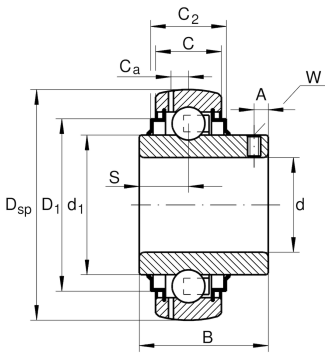
**Main Dimensions & Performance Data**

d	45 mm	Bore diameter
D _{SP}	85 mm	Outside diameter
B	49,2 mm	Width
C _{0r}	20.400 N	Basic static load rating, radial
C _{ur}	680 N	Fatigue load limit, radial
C _r	32.500 N	Basic dynamic load rating, radial
≈m	0,67 kg	Weight

Dimensions

C	22 mm	Width, outer ring
C ₂	26,4 mm	Sealing total width
S	19 mm	Distance raceway
d ₁	57 mm	Rib diameter inner ring
D ₁	72,3 mm	Outside diameter seal
C _a	6,4 mm	Distance to lubrication hole
A	8 mm	Distance thread
W	4 mm	Width of flats

Calculation factors

f ₀	14,1	Calculation factor
----------------	------	--------------------



Characteristics

-  Radial load
-  Axial load in one direction
-  Axial load in two directions
-  Lifetime lubrication, freedom from maintenance
-  Grease Lubrication
-  Sealed on both sides
-  Static angular error and misalignment