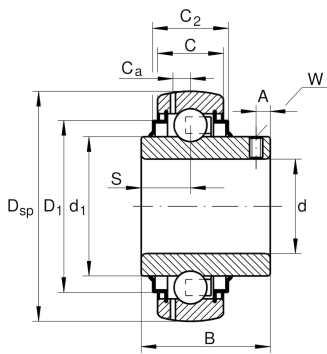

**GYE50-211-KRR-B** [↗](#)

Radial insert ball bearing

Radial insert ball bearing GYE...-211-KRR-B

Technical information

**Main Dimensions & Performance Data**

d	50 mm	Bore diameter
D _{SP}	100 mm	Outside diameter
B	55,6 mm	Width
C _{0r}	29.000 N	Basic static load rating, radial
C _{ur}	1.240 N	Fatigue load limit, radial
C _r	43.500 N	Basic dynamic load rating, radial
≈m	1,26 kg	Weight

Dimensions

C	25 mm	Width, outer ring
C ₂	29 mm	Sealing total width
S	22,2 mm	Distance raceway
d ₁	69,8 mm	Rib diameter inner ring
D ₁	85,9 mm	Outside diameter seal
C _a	7 mm	Distance to lubrication hole
A	9 mm	Distance thread
W	4 mm	Width of flats

Temperature range

T _{min}	-20 °C	Operating temperature min.
T _{max}	120 °C	Operating temperature max.



Calculation factors

f_0	14,2	Calculation factor
-------	------	--------------------

Characteristics

-  Radial load
-  Axial load in one direction
-  Axial load in two directions
-  Lifetime lubrication, freedom from maintenance
-  Grease Lubrication
-  Sealed on both sides
-  Static angular error and misalignment