

RAE25-XL-NPP-NR

Radial insert ball bearing

Radial insert ball bearings RAE..-NPP-NR, cylindrical outer ring, location by eccentric locking collar, slots in outer ring, P seals on both sides

X-life

Technical information

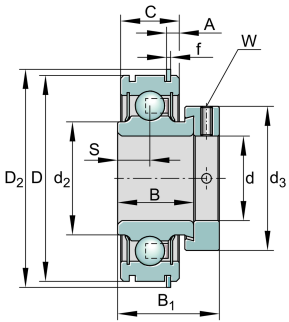

Main Dimensions & Performance Data

d	25 mm	Bore diameter
D	52 mm	Outside diameter
B	21,4 mm	Width
B ₁	31 mm	Locking collar total width
C _r	14.000 N	Basic dynamic load rating, radial
C _{0r}	7.800 N	Basic static load rating, radial
C _{ur}	410 N	Fatigue load limit, radial
≈m	0,2 kg	Weight



Dimensions

C	15 mm	Width, outer ring
S	7,5 mm	Distance raceway
d ₂	30,5 mm	Rib diameter sealing inner ring
d ₃	37,5 mm	Outside diameter locking collar/locknut
A	3,58 mm	Distance snap ring
	0 mm	Upper distance retaining ring tolerance
	-0,25 mm	Lower distance retaining ring tolerance
W	3 mm	Width of flats
D ₂	57,9 mm	Outside diameter snap ring
	0 mm	Upper width snap ring tolerance
	-0,1 mm	Lower width snap ring tolerance

Calculation factors

f ₀	13,8	Calculation factor
----------------	------	--------------------