

## RAE20-XL-NPP-NR

### Radial insert ball bearing

Radial insert ball bearings RAE..-NPP-NR, cylindrical outer ring, location by eccentric locking collar, slots in outer ring, P seals on both sides

X-life

## Technical information

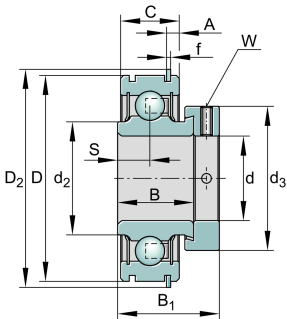

### Main Dimensions & Performance Data

d	20 mm	Bore diameter
D	47 mm	Outside diameter
B	21,4 mm	Width
B <sub>1</sub>	31 mm	Locking collar total width
C <sub>r</sub>	12.800 N	Basic dynamic load rating, radial
C <sub>0r</sub>	6.600 N	Basic static load rating, radial
C <sub>ur</sub>	345 N	Fatigue load limit, radial
≈m	0,17 kg	Weight



### Dimensions

C	14 mm	Width, outer ring
S	7,5 mm	Distance raceway
d <sub>2</sub>	26,9 mm	Rib diameter sealing inner ring
d <sub>3</sub>	33 mm	Outside diameter locking collar/locknut
A	3,58 mm	Distance snap ring
	0 mm	Upper distance retaining ring tolerance
	-0,25 mm	Lower distance retaining ring tolerance
W	3 mm	Width of flats
D <sub>2</sub>	52,7 mm	Outside diameter snap ring
	0 mm	Upper width snap ring tolerance
	-0,1 mm	Lower width snap ring tolerance

### Calculation factors

f <sub>0</sub>	13,1	Calculation factor
----------------	------	--------------------