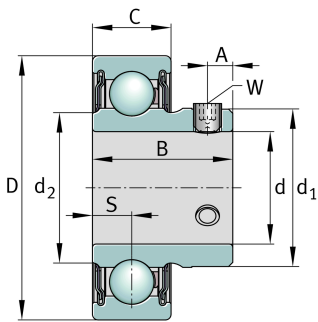

IMAGE  
COMING SOON**AY25-NPP**

Radial insert ball bearing

Radial insert ball bearing AY..-NPP

## Technical information

**Main Dimensions & Performance Data**

d	25 mm	Bore diameter
D	52 mm	Outside diameter
B	27 mm	Width
C <sub>r</sub>	14.900 N	Basic dynamic load rating, radial
C <sub>0r</sub>	7.800 N	Basic static load rating, radial
≈m	0,16 kg	Weight

**Dimensions**

C	15 mm	Width, outer ring
S	7,5 mm	Distance raceway
d <sub>1</sub>	33,5 mm	Rib diameter inner ring
d <sub>2</sub>	30,4 mm	Rib diameter sealing inner ring
A	5 mm	Distance thread
W	2,5 mm	Width of flats

**Temperature range**

T <sub>min</sub>	-20 °C	Operating temperature min.
T <sub>max</sub>	120 °C	Operating temperature max.



### Characteristics

---



Radial load



Axial load in one direction



Axial load in two directions



Lifetime lubrication, freedom from maintenance



Grease Lubrication



Sealed on both sides