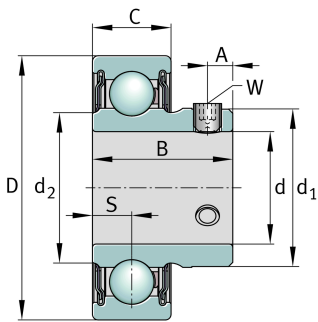

IMAGE
COMING SOON**AY20-NPP**

Radial insert ball bearing

Radial insert ball bearing AY..-NPP

Technical information

**Main Dimensions & Performance Data**

d	20 mm	Bore diameter
D	47 mm	Outside diameter
B	25 mm	Width
C_r	13.600 N	Basic dynamic load rating, radial
C_{0r}	6.600 N	Basic static load rating, radial
$\approx m$	0,13 kg	Weight

Dimensions

C	14 mm	Width, outer ring
S	7 mm	Distance raceway
d_1	28,2 mm	Rib diameter inner ring
d_2	26,7 mm	Rib diameter sealing inner ring
A	4,5 mm	Distance thread
W	2,5 mm	Width of flats

Temperature range

T_{min}	-20 °C	Operating temperature min.
T_{max}	120 °C	Operating temperature max.



Characteristics



Radial load



Axial load in one direction



Axial load in two directions



Lifetime lubrication, freedom from maintenance



Grease Lubrication



Sealed on both sides