

IMAGE  
COMING SOON**209-XL-NPP-B-C3** [↗](#)

Self-aligning deep groove ball bearings

Self-aligning deep groove ball bearings 2..-  
NPP-B, spherical outer ring, inner ring for fit,  
R seals on both sides

X-life

## Technical information

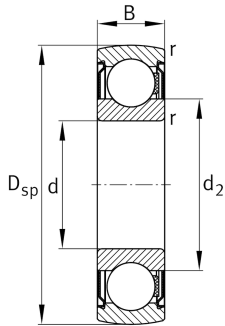

## Your current product variant

Sealing	NPP	
Shape of outer surface	B	Spherical

## Main Dimensions &amp; Performance Data

d	45 mm	Bore diameter
D <sub>SP</sub>	85 mm	Outside diameter
B	19 mm	Width
C <sub>r</sub>	34.500 N	Basic dynamic load rating, radial
C <sub>0r</sub>	20.400 N	Basic static load rating, radial
m	0,37 kg	Weight

## Dimensions

d <sub>2</sub>	53,2 mm	Rib diameter sealing inner ring
r <sub>min</sub>	1,1 mm	Minimum chamfer dimension

## Temperature range

T <sub>min</sub>	-20 °C	Operating temperature min.
T <sub>max</sub>	100 °C	Operating temperature max.

## Calculation factors

f <sub>0</sub>	14,1	Calculation factor
----------------	------	--------------------



## Characteristics

---

-  Radial load
-  Axial load in one direction
-  Axial load in two directions
-  Lifetime lubrication, freedom from maintenance
-  Grease Lubrication
-  Sealed on both sides
-  Static angular error and misalignment