

**FAG****4207-BB-TVH** [↗](#)

## Deep groove ball bearing

Deep groove ball bearing 42...-BB-TVH,  
double row, plastic cage

## Technical information

## Your current product variant

Design variant	B	Bearing without filling slot
Tolerance class	PN	Normal (ISO 492:2023)
Changed internal design	B	B
Cage	TVH	Solid cage made of glass-fiber reinforced polyamid PA66
Lubricant	GA13	Ball bearing and insert bearing grease
Dimensional / heat stabilization	SN	Rings dimensional stabilized up to 120°
Radial internal clearance	CN (Group N)	Normal internal clearance

## Main Dimensions &amp; Performance Data

d	35 mm	Bore diameter
D	72 mm	Outside diameter
B	23 mm	Width
$C_r$	39.500 N	Basic dynamic load rating, radial
$C_{0r}$	30.000 N	Basic static load rating, radial
$C_{ur}$	1.570 N	Fatigue load limit, radial
$n_G$	9.300 1/min	Limiting speed
$n_{gr}$	8.700 1/min	Reference speed
$\approx m$	0,391 kg	Weight

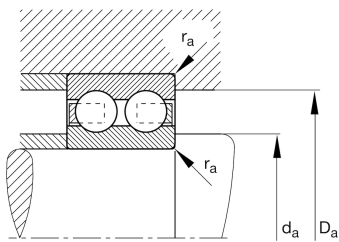
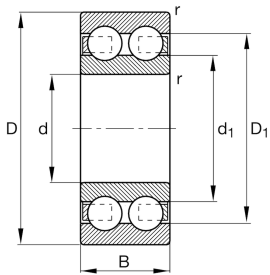



### Mounting dimensions

$d_{a \min}$	42 mm	Minimum diameter shaft shoulder
$D_{a \max}$	65 mm	Maximum diameter of housing shoulder
$r_{a \max}$	1 mm	Maximum fillet radius

### Dimensions

$r_{\min}$	1,1 mm	Minimum chamfer dimension
$D_1$	60,6 mm	Shoulder diameter outer ring
$d_1$	46,3 mm	Shoulder diameter inner ring



### Temperature range

$T_{\min}$	-20 °C	Operating temperature min.
$T_{\max}$	120 °C	Operating temperature max.

### Calculation factors

$f_0$	14,1	Calculation factor
-------	------	--------------------

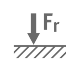
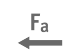
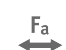
### Characteristics

-  Radial load
-  Axial load in one direction
-  Axial load in two directions
-  Grease Lubrication
-  Not sealed