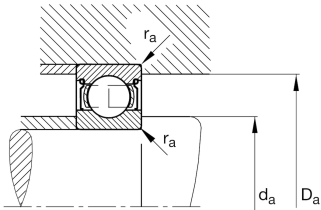

**FAG****16100-A-2Z**

Deep groove ball bearing

Deep groove ball bearing 161...-2Z, single row, shields, steel sheet metal cage

## Technical information

**Your current product variant**

Changed internal design	A	Design variant A
Sealing	2Z	Non-contact shield on both sides
Cage	JN	Steel sheet metal
Tolerance class	PN	Normal (ISO 492:2023)
Dimensional / heat stabilization	SN	Rings dimensional stabilized up to 120°
Lubricant	Lubricating grease	
Radial internal clearance	CN (Group N)	Normal internal clearance
Bore type	Z	Cylindrical

**Main Dimensions & Performance Data**

d	10 mm	Bore diameter
D	28 mm	Outside diameter
B	8 mm	Width
C <sub>r</sub>	4.850 N	Basic dynamic load rating, radial
C <sub>0r</sub>	1.970 N	Basic static load rating, radial
C <sub>ur</sub>	145 N	Fatigue load limit, radial
n <sub>G</sub>	34.500 1/min	Limiting speed
n <sub>gr</sub>	28.500 1/min	Reference speed
m	0,025 kg	Weight



### Mounting dimensions

$d_{a \min}$	12,4 mm	Minimum diameter shaft shoulder
$D_{a \max}$	25,6 mm	Maximum diameter of housing shoulder
$r_{a \max}$	0,3 mm	Maximum fillet radius

### Dimensions

$r_{\min}$	0,3 mm	Minimum chamfer dimension
$D_1$	21,08 mm	Shoulder diameter outer ring
$D_2$	22,7 mm	Caliber diameter outer ring
$d_1$	14,65 mm	Shoulder diameter inner ring

### Temperature range

$T_{\min}$	-20 °C	Operating temperature min.
$T_{\max}$	120 °C	Operating temperature max.

### Calculation factors

$f_0$	12,4	Calculation factor
-------	------	--------------------

### Characteristics

	Radial load
	Axial load in one direction
	Axial load in two directions
	Lifetime lubrication, freedom from maintenance
	Grease Lubrication
	Sealed on both sides