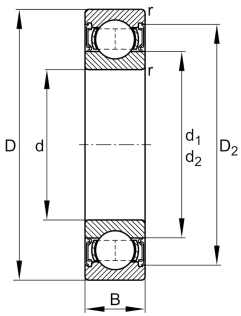

**FAG****6213-2RSR**

Deep groove ball bearing

Deep groove ball bearing 62...-2RSR, single row, seals, steel sheet metal cage

Technical information

**Your current product variant**

Sealing	2RSR	Contact seal on both sides
Cage	JN	Steel sheet metal
Tolerance class	PN	Normal (PN)
Dimensional / heat stabilization	S0	Rings dimensional stabilized up to 150°
Lubricant	GA13	Ball bearing and insert bearing grease
Radial internal clearance	CN (Group N)	Normal internal clearance
Bore type	Z	Cylindrical

Main Dimensions & Performance Data

d	65 mm	Bore diameter
D	120 mm	Outside diameter
B	23 mm	Width
C_r	63.000 N	Basic dynamic load rating, radial
C_{0r}	41.500 N	Basic static load rating, radial
C_{ur}	2.850 N	Fatigue load limit, radial
n_G	3.250 1/min	Limiting speed
m	0,964 kg	Weight

Mounting dimensions

$d_{a \min}$	74 mm	Minimum diameter shaft shoulder
$D_{a \max}$	111 mm	Maximum diameter of housing shoulder
$r_{a \max}$	1,5 mm	Maximum fillet radius



Dimensions

r_{\min}	1,5 mm	Minimum chamfer dimension
D_1	103,16 mm	Shoulder diameter outer ring
D_2	106,34 mm	Caliber diameter outer ring
d_1	82 mm	Shoulder diameter inner ring

Temperature range

T_{\min}	-20 °C	Operating temperature min.
T_{\max}	100 °C	Operating temperature max.

Calculation factors

f_0	14,4	Calculation factor
-------	------	--------------------

Characteristics



Radial load



Axial load in one direction



Axial load in two directions



Lifetime lubrication, freedom from maintenance



Grease Lubrication



Sealed on both sides