

**GE100-LO**

## Spherical plain bearing

High performance Radial spherical plain bearing, requiring maintenance, sliding contact surface: steel/steel, DIN ISO 12240-1, dimension series W, cylindrical extensions on inner ring, open design High-performance: For highest load rating and lifetime demands

## Technical information

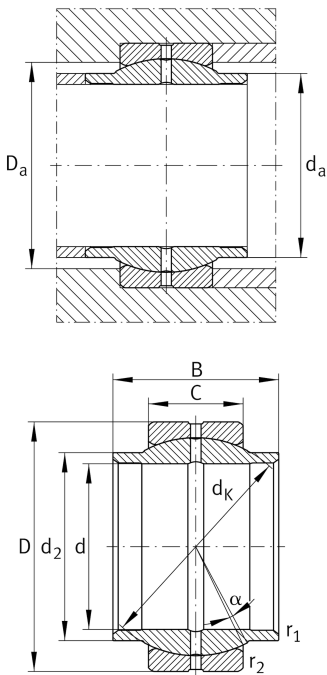

## Your current product variant

Maintenance	Maintenance required
Material	Steel
Sealing	Without
Radial internal clearance	CN (Group N) Normal internal clearance
Coating	Durotect M Inner- and outer ring coated with Durotect M (Manganese Phosphate)

## Main Dimensions &amp; Performance Data

d	100 mm	Bore diameter bearing
D	150 mm	Outside diameter bearing
B	100 mm	Width inner ring
C <sub>r</sub>	790.000 N	Basic dynamic load rating, radial
C <sub>0r</sub>	3.040.000 N	Basic static load rating, radial
≈m	4,888 kg	Weight

## Mounting dimensions

r <sub>1smin</sub>	1 mm	Edge Spacing
r <sub>2smin</sub>	1 mm	Edge Spacing
d <sub>a max</sub>	113 mm	Connection measure Inner ring
D <sub>a min</sub>	123 mm	Housing Connection Diameter



## Dimensions

C	55 mm	Width Outer ring
$d_K$	130 mm	Ball diameter
$\alpha$	4 °	Tilt angle
$d_{OT}$	0,035 mm	Bore diameter bearing, upper tolerance
$d_{UT}$	0 mm	Bore diameter bearing, lower tolerance
$D_{OT}$	0 mm	Outside diameter, upper tolerance
$D_{UT}$	-0,018 mm	Outside diameter, lower tolerance
$B_{OT}$	0 mm	Width inner ring, upper tolerance
$B_{UT}$	-0,35 mm	Width inner ring, lower tolerance
$C_{OT}$	0 mm	Width outer ring, upper tolerance
$C_{UT}$	-0,5 mm	Width outer ring, lower tolerance
$G_r$	0,085 - 0,165	Radial Clearance
$G_{rmax}$	0,165 mm	Radial clearance, maximum
$G_{rmin}$	0,085 mm	Radial clearance, minimum

## Temperature range

$T_{min}$	-60 °C	Operating temperature min.
$T_{max}$	200 °C	Operating temperature max.

## Characteristics

-  Radial load
-  Axial load in one direction
-  Axial load in two directions
-  Grease Lubrication
-  Not sealed
-  Static angular error and misalignment
-  Dynamic angular error and misalignment