

**GIL40-DO-2RS**

## Rod end



Rod end with internal thread, left hand thread, requiring maintenance, sliding contact surface: steel/steel, DIN ISO 12240-4, dimension series E, type F, sealed

## Technical information

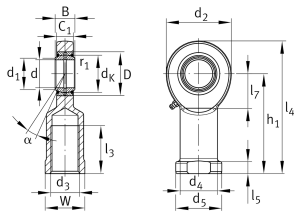

## Your current product variant

Clampable	Not clampable	
Maintenance	Maintenance required	
Lubrication nipple	DIN71412-AS6 (tapered grease nipple)	
Slotted	No	
Thread Pitch	Left-hand thread	
Type of Seal	2RS	Lip seals on both sides
Radial internal clearance	CN (Group N)	Normal internal clearance
Mounting	Internal thread	

## Main Dimensions &amp; Performance Data

d	40 mm	Bore diameter bearing
D	62 mm	Outside diameter bearing
B	28 mm	Width inner ring
C <sub>r</sub>	129.000 N	Basic dynamic load rating, radial
C <sub>0r</sub>	194.000 N	Basic static load rating, radial
G <sub>r</sub>	0,043 - 0,12	Radial Clearance
≈m	2,069 kg	Weight



## Dimensions

d <sub>K</sub>	53 mm	Ball diameter
d <sub>1</sub>	45 mm	Outer flange diameter inner ring
d <sub>2</sub>	92 mm	Outer eye diameter
d <sub>3</sub>	M39x3	Thread size
d <sub>4</sub>	52 mm	Shank diameter
h <sub>1</sub>	142 mm	Shank Length Internal thread head
C <sub>1</sub>	23 mm	Width of the rod end
α	7 °	Tilt angle
l <sub>3</sub>	65 mm	Thread length Internal thread
l <sub>4</sub>	188 mm	Total length internal thread head
l <sub>5</sub>	18 mm	Length rod end shank
l <sub>7</sub>	48 mm	Distance drilling with/shaft start
d <sub>5</sub>	65 mm	Shank diameter, large
r <sub>1smin</sub>	0,6 mm	Edge Spacing
W	55 mm	Width Across Flat
d <sub>OT</sub>	0 mm	Bore diameter bearing, upper tolerance
d <sub>UT</sub>	-0,012 mm	Bore diameter bearing, lower tolerance
B <sub>OT</sub>	0 mm	Width inner ring, upper tolerance
B <sub>UT</sub>	-0,12 mm	Width inner ring, lower tolerance
G <sub>rmax</sub>	0,12 mm	Radial clearance, maximum
G <sub>rmin</sub>	0,043 mm	Radial clearance, minimum

## Temperature range

T <sub>min</sub>	-30 °C	Operating temperature min.
T <sub>max</sub>	130 °C	Operating temperature max.



### Characteristics

---



Radial load



Grease Lubrication



Sealed on both sides



Static angular error and misalignment



Dynamic angular error and misalignment