

**GAR30-DO**

Rod end



Rod end with external thread, right hand thread, requiring maintenance, sliding contact surface: steel/steel, DIN ISO 12240-4, dimension series E, type M, open

Technical information

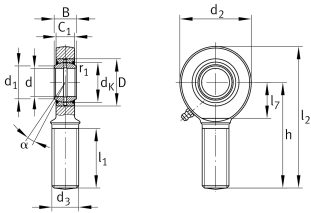
**Your current product variant**

Clampable	Not clampable	
Maintenance	Maintenance required	
Mounting	External thread	
Lubrication nipple	DIN71412-AS6 (tapered grease nipple)	
Slotted	No	
Thread Pitch	Right-hand thread	
Sealing	Without	
Radial internal clearance	CN (Group N)	Normal internal clearance

Main Dimensions & Performance Data

C_r	81.000 N	Basic dynamic load rating, radial
C_{0r}	119.000 N	Basic static load rating, radial
d	30 mm	Bore diameter bearing
D	47 mm	Outside diameter bearing
l_2	146,5 mm	Total length external thread head
B	22 mm	Width inner ring
d_2	73 mm	Outer eye diameter
$\approx m$	0,932 kg	Weight



Mounting dimensions

d ₁	34,2 mm	Outer flange diameter inner ring
r _{1smin}	0,6 mm	Edge Spacing

Dimensions

d _K	40,7 mm	Ball diameter
d ₃	M30x2	Thread size
h	110 mm	Shank Length External thread rod
C ₁	19 mm	Width of the rod end
α	6 °	Tilt angle
l ₁	65 mm	Shank Length External thread head
l ₇	37 mm	Distance drilling with/shaft start
d _{OT}	0 mm	Bore diameter bearing, upper tolerance
d _{UT}	-0,01 mm	Bore diameter bearing, lower tolerance
B _{OT}	0 mm	Width inner ring, upper tolerance
B _{UT}	-0,12 mm	Width inner ring, lower tolerance
G _r	0,037 - 0,1	Radial Clearance
G _{rmax}	0,1 mm	Radial clearance, maximum
G _{rmin}	0,037 mm	Radial clearance, minimum

Temperature range

T _{min}	-60 °C	Operating temperature min.
T _{max}	200 °C	Operating temperature max.



Characteristics



Radial load



Grease Lubrication



Not sealed



Static angular error and misalignment



Dynamic angular error and misalignment