

**GAL50-DO-2RS** [↗](#)

Rod end



Rod end with external thread, left hand thread, requiring maintenance, sliding contact surface: steel/steel, DIN ISO 12240-4, dimension series E, type M, sealed design

Technical information

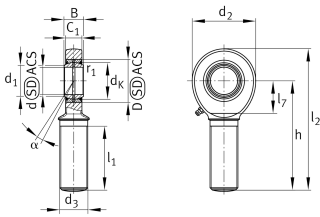
**Your current product variant**

Clampable	Not clampable	
Maintenance	Maintenance required	
Lubrication nipple	DIN71412-AS6 (tapered grease nipple)	
Slotted	No	
Thread Pitch	Left-hand thread	
Type of Seal	2RS	Lip seals on both sides
Radial internal clearance	CN (Group N)	Normal internal clearance
Mounting	External thread	

Main Dimensions & Performance Data

C_r	204.000 N	Basic dynamic load rating, radial
C_{0r}	314.000 N	Basic static load rating, radial
d	50 mm	Bore diameter bearing
D	75 mm	Outside diameter bearing
l_2	241 mm	Total length external thread head
B	35 mm	Width inner ring
d_2	112 mm	Outer eye diameter
$\approx m$	3,53 kg	Weight



Mounting dimensions

d ₁	55,9 mm	Outer flange diameter inner ring
r _{1smin}	0,6 mm	Edge Spacing

Dimensions

d _K	66 mm	Ball diameter
d ₃	M45x3	Thread size
h	185 mm	Shank Length External thread rod
C ₁	30 mm	Width of the rod end
α	6 °	Tilt angle
l ₁	107 mm	Shank Length External thread head
l ₇	60 mm	Distance drilling with/shaft start
d _{OT}	0 mm	Bore diameter bearing, upper tolerance
d _{UT}	-0,012 mm	Bore diameter bearing, lower tolerance
B _{OT}	0 mm	Width inner ring, upper tolerance
B _{UT}	-0,12 mm	Width inner ring, lower tolerance
G _r	0,043 - 0,12	Radial Clearance
G _{rmax}	0,12 mm	Radial clearance, maximum
G _{rmin}	0,043 mm	Radial clearance, minimum

Temperature range

T _{min}	-30 °C	Operating temperature min.
T _{max}	130 °C	Operating temperature max.



Characteristics



Radial load



Grease Lubrication



Sealed on both sides



Static angular error and misalignment



Dynamic angular error and misalignment