



FAG

SES510-608-L

Plummer block housing

Split plummer block housing for various bearing designs. The SNV series will be replaced by the new SES series in 2022.

Technical information

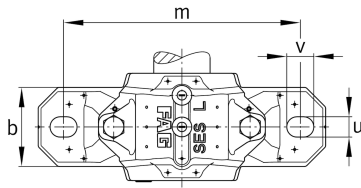

Main Dimensions & Performance Data

D	90 mm	Outside diameter bearing
a	205 mm	Length base
h ₁	113 mm	Height
g	90 mm	Width housing body
K	41 mm	Width bearing seat
≈m	3,27 kg	Weight



Dimensions

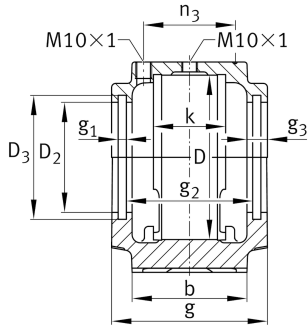
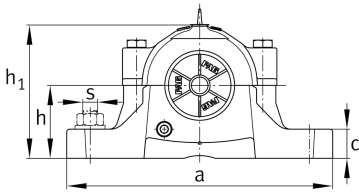

b	60 mm	Width base
c	25 mm	Height base
h	60 mm	Base to shaft centerline height
m	170 mm	Distance fixing bore
s	12,7 mm	Screw size
s	M12	Size of fixing screws
u	15 mm	Width slot
v	20 mm	Length slot
D ₂	62 mm	Diameter sealing
D ₃	70,5 mm	Diameter sealing groove
D ₅	68,7 mm	Outside diameter sealing labyrinth
g ₁	5 mm	Width sealing groove
g ₂	72 mm	Distance sealing
g ₃	12 mm	Wall thickness
g ₄	34 mm	Distance oil lubrication
m ₁	140 mm	Distance holes aligned pins m1
n ₃	54 mm	Distance lubrication
n ₄	76 mm	Distance lubrication sealing
u ₁	6 mm	Bore diameter u1
u ₂	11 mm	Bore diameter u2