

**FAG****51284-MP**

Axial deep groove ball bearing

Axial deep groove ball bearing 512...MP,
single direction, solid brass cage

Technical information

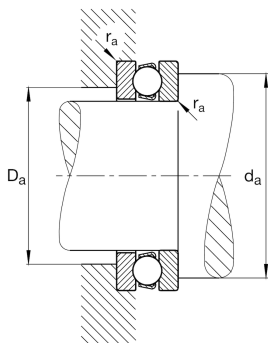

Your current product variant

Cage	MP	Solid brass cage, rolling element guided
Tolerance class	PN	Normal (ISO 492:2023)
Dimensional / heat stabilization	S1	Rings dimensional stabilized up to 200°

Main Dimensions & Performance Data

d	420 mm	Inner diameter shaft washer
D	580 mm	Outer diameter housing washer
T	130 mm	Height
C _a	870.000 N	Basic dynamic load rating, axial
C _{0a}	5.100.000 N	Basic static load rating, axial
C _{ua}	104.000 N	Fatigue load limit, axial
n _G	690 1/min	Limiting speed
n _{gr}	750 1/min	Reference speed
m	106 kg	Weight

Mounting dimensions

d _{a min}	516 mm	Minimum diameter shaft shoulder
D _{a max}	484 mm	Maximum diameter of housing shoulder
r _{a max}	4 mm	Maximum filled radius



Dimensions

r_{\min}	5 mm	Minimum chamfer dimension
D_1	425 mm	Inner diameter housing washer
d_1	575 mm	Outer diameter shaft washer

Temperature range

T_{\min}	-30 °C	Operating temperature min.
T_{\max}	200 °C	Operating temperature max.

Calculation factors

A	141	Minimum load factor
---	-----	---------------------

Characteristics

-  Axial load in one direction
-  Grease Lubrication
-  Oil Lubrication
-  Not sealed
-  Large bearing